

## LT5WRG050-00-1-B-24V-CH4

### Lighting Dimension

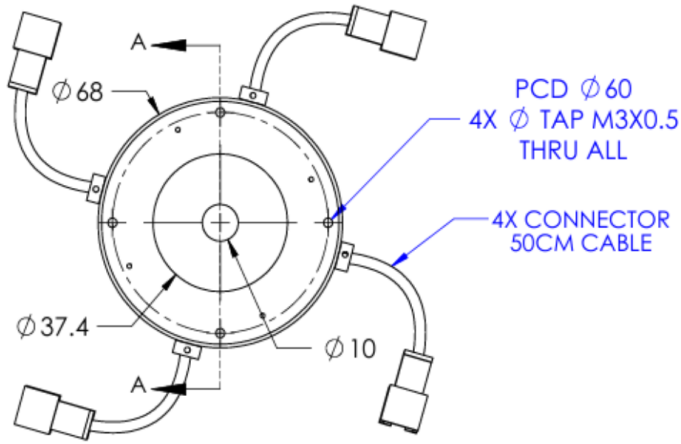

SECTION A-A

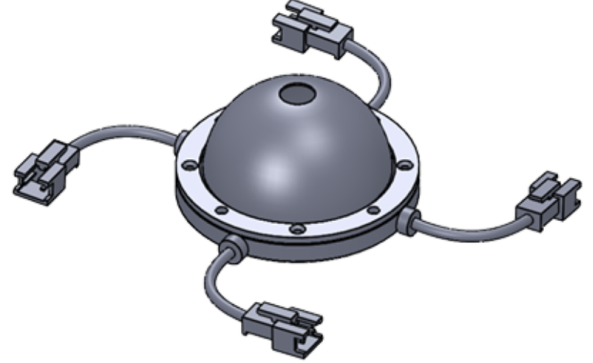
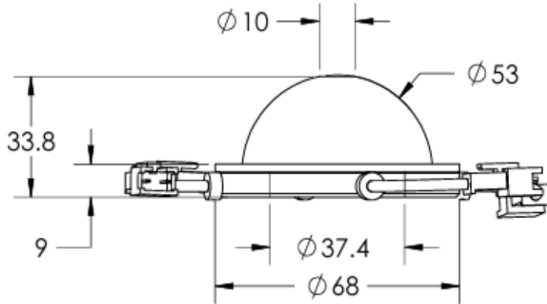

### Mechanical Information

Casing Material	Aluminium
Storage Temperature Range	0 - 45°C
Storage Humidity Range	20 - 85%
Weight	89g
Width / Inner Diameter	10mm
Length / Outer Diameter	68mm
Height / Thickness	33.8mm

Strobe Mode Specification								
*Normal Strobe Voltage	24V							
*Normal Strobe Current	70mA		70mA		70mA		70mA	
Overdrive Voltage Range	Min: 36V	Max: 48V	Min: 36V	Max: 48V	Min: 36V	Max: 48V	Min: 36V	Max: 48V
Overdrive Current Range	Min: 716mA	Max: 1153mA	Min: 716mA	Max: 1153mA	Min: 716mA	Max: 1163mA	Min: 716mA	Max: 1153mA
Recommended Overdrive Voltage	36V		36V		36V		36V	
**Max. Trigger Pulse Duration	10%							

# ILLUMINATOR DATA

## LT5WRG050-00-1-B-24V-CH4

Connection Information			
Connector Type	JST SMR-03V-B		
Cable Length	500mm		
Pin Configuration 	Pin	Signal	Cable Color
	1	24V	RED
	2	-	-
	3	GND	WHITE / BLACK
			

Additional Information	
Additional Cooling Method	Attached to machine part for better heat dissipation
Intensity Controller Selection	LTIC series
CE Conformity	YES
RoHS Compliance	YES

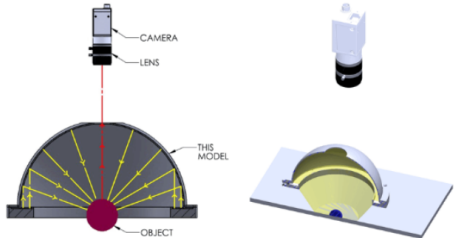
Application	
Illumination Type	4 Sectional Illumination
Application Use	<ul style="list-style-type: none"> <li>Cracks, Chips, Stains &amp; Marks on Circular or Cylindrical Objects Inspection</li> <li>Solder and Substrate Inspection</li> </ul> 

# ILLUMINATOR DATA

## LT5WRG050-00-1-B-24V-CH4

Lighting Pattern				
Working Distance	For further details, please contact us			
Display and Image	For further details, please contact us			
Data Results	Horizontal	Meas. (mm)	Vertical	Meas. (mm)
	90%	N.A.	90%	N.A.
	90%	N.A.	90%	N.A.
	80%	N.A.	80%	N.A.
	70%	N.A.	70%	N.A.
	60%	N.A.	60%	N.A.
	50%	N.A.	50%	N.A.
	40%	N.A.	40%	N.A.
	30%	N.A.	30%	N.A.
	20%	N.A.	20%	N.A.
	10%	N.A.	10%	N.A.